



Vic Systems

Presents



GOLD WING BROILER Production Systems

Simple, effective and complete
management system for
raising broilers.



GOLD WING BROILER Objectives :

- Improve feed efficiency
- Faster rate of gain
- Improved flock uniformity
- Less condemnations
- Lower mortality

VENTILATION CONTROLS

Expert 64CA Control



- Two variable stages
- Thirteen on/off stages
- 8 heat stages
- 3 misting stages
- Up to 12 inlet stages

Expert RP Relay Panel



- Up to 64 relay outputs
- 3 way On/Off/Auto switch for each relay

Humidity Probe

- Manage minimum ventilation
- Control ammonia and humidity for good air quality



Monocoque Fans

- One piece fan and hood
- Perfect for minimum ventilation stages



Vortex Fans

- Fiberglass housings, Cast aluminum blade, Cone
- High CFM, Excellent CFM/Watt, Bess Lab certified
- Ideal for intermediate, maximum and tunnel stages



EXHAUST FANS

Chimney Fans

- MultiMax motors from Multifan
- Damper control



Modular Inlets

Modular inlet provides precise air speed and direction during minimum ventilation



Baffle Inlets

Continuous inlet provides even air pattern during intermediate and maximum ventilation

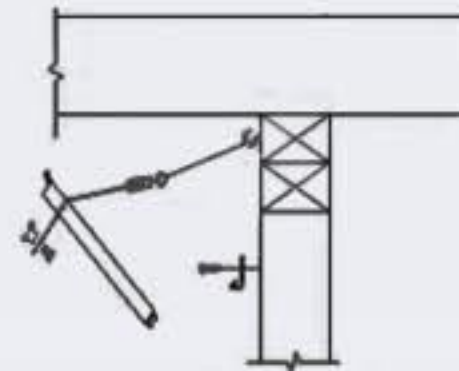

AIR INLETS

Inlet Actuators

Durable Vic Jack actuator provides precise inlet opening and closing



SUPER COOL MISTING

Slip-Lok Misting Line

Easy to install mist nozzle at exact locations for best cooling effect



Super Cool Control

Relative humidity strategy allows cooling to start before temperature affects feed intake



WATER METER

Water Meter

Detect equipment problem or disease outbreak Track daily usage





FEED WEIGHING

Differences in growth rate are mostly differences in feed intake.

It's impossible to optimize feed conversion and weight gain if you don't know how daily changes are affecting feed intake.



Feed Weigher

Simple, accurate feed weighing

- Load cells are inside
- Shows daily and cumulative feed consumption
- Automatic bin rotation



Bin Weigher

- Accurate feed inventory management
- Shows daily and cumulative feed consumption
- Automatic bin rotation

FEEDING CONTROLS

Auger Manager Control

- Current operating status
- Daily and cumulative run time for fill and feed line augers
- Maximum run time curve
- Alarm for max run and max off time



Feed Master Control for Wheat Feeding

- Accurately blend up to six ingredients
- Ten point feed blending curve
- Companion to the Feed Weigher scale



LIGHTING CONTROLS

LD-7000 Model

Create precise light programs

- Light peaks
- Sunrise / sunset simulation
- Manual mode
- Auto mode



AGRI-ALERT

- Four models to match facility needs
- From 8 to 96 zones for temperature, dry contacts, bio-security
- Auto dial



BIRD WEIGHING

- Provides early warning on bird health
- Provides accurate shipping weight control
- Daily weight deviation of flock
- Daily uniformity bandwidth of flock
- Daily average weight



Platforms are not in the litter



GOLD WING BROILER provides daily performance information for management to make simple, concise decisions to improve all elements of production :

- Daily and cumulative feed intake
- Flock uniformity
- Daily and cumulative weight gain
- Water consumption

Knowing this information gives the broiler producer immediate recognition of specific problems so that changes can be made at the time of the incident rather than waiting until the flock ships and there are no clues as to what happened.

For example :

- Overcrowding in parts of the house
- Disease outbreak
- Effect of a ration change
- Feed problem
- Equipment problem
- Temperature fluctuations
- Etc.

Enhanced management with E2E software

- Web based. Needs only Internet Explorer to view all information and reports.
- Multiple users can access data simultaneously.
- Automatically generates reports on a daily basis or as specified.
- Automatically sends emails to specified recipients.
- Automatically downloads information to the hard drive for up to two years.



For more information on **GOLD WING BROILER** please call :

Authorized dealer



5200 Armand-Frappier
 St-Hubert, (Qc) Canada J3Z 1G5
 Toll free : 1-800-567-0550
 Fax : (450) 926-2780
 sales@vicsystems.com
 www.vicsystems.com